

NO HYD SYM

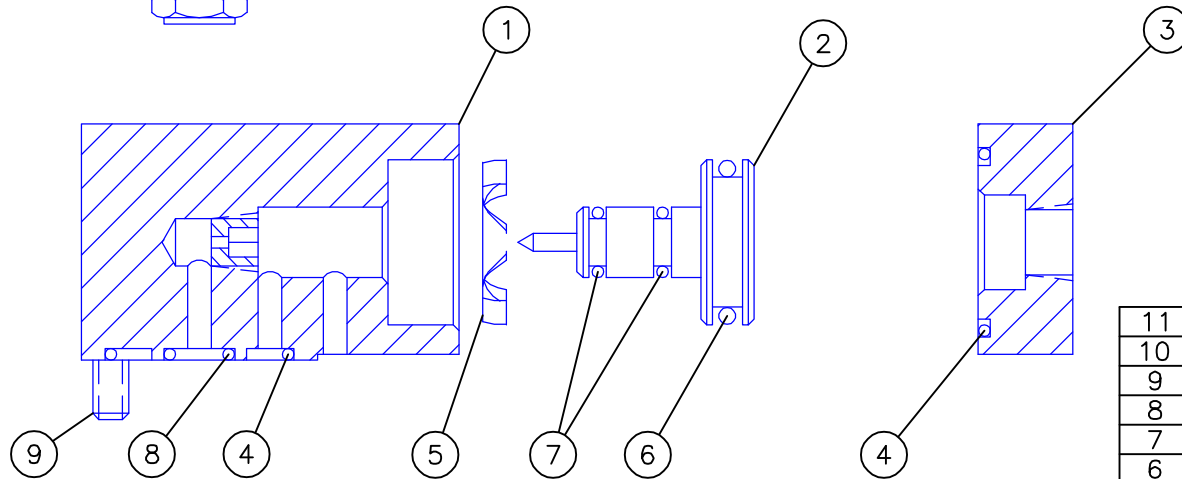

11	2	6-32 x .50	SCREW, SOC HD CAP
10	1	EP-114	BREATHER
9	2	10-24 x .88	SCREW, SOC HD CAP
8	1	SO-010D7	O-RING
7	2	SO-010B7	O-RING
6	1	SO-115B7	O-RING
5	1	F0846-006	FINGER SPRING
4	2	SO-020B7	O-RING
3	1	EP-450-3	CAP
2	1	EP-450-2	PISTON/NEEDLE
1	1	EP-450-1	HOUSING & SEAT
ITEM	QTY	PART NUMBER	DESCRIPTION



INTERFACE DEVICES, INC.
230 DEPOT ROAD
MILFORD, CT 06460

DESCRIPTION: A SUBPLATE MOUNTED, NORMALLY OPEN, ZERO-LEAKAGE, 10,000 PSI HYDRAULIC DUMP VALVE-AIR PILOT OPERATED (65 PSI MIN).

SCALE: FULL

TITLE: DUMP VALVE ASSY
(NORMALLY OPEN)

DWN BY: TWH

DATE: 5/12/93

REF:

SHT: 1 OF: 1

DWG NO: EP-451

REV: